

9060
South Copy 1

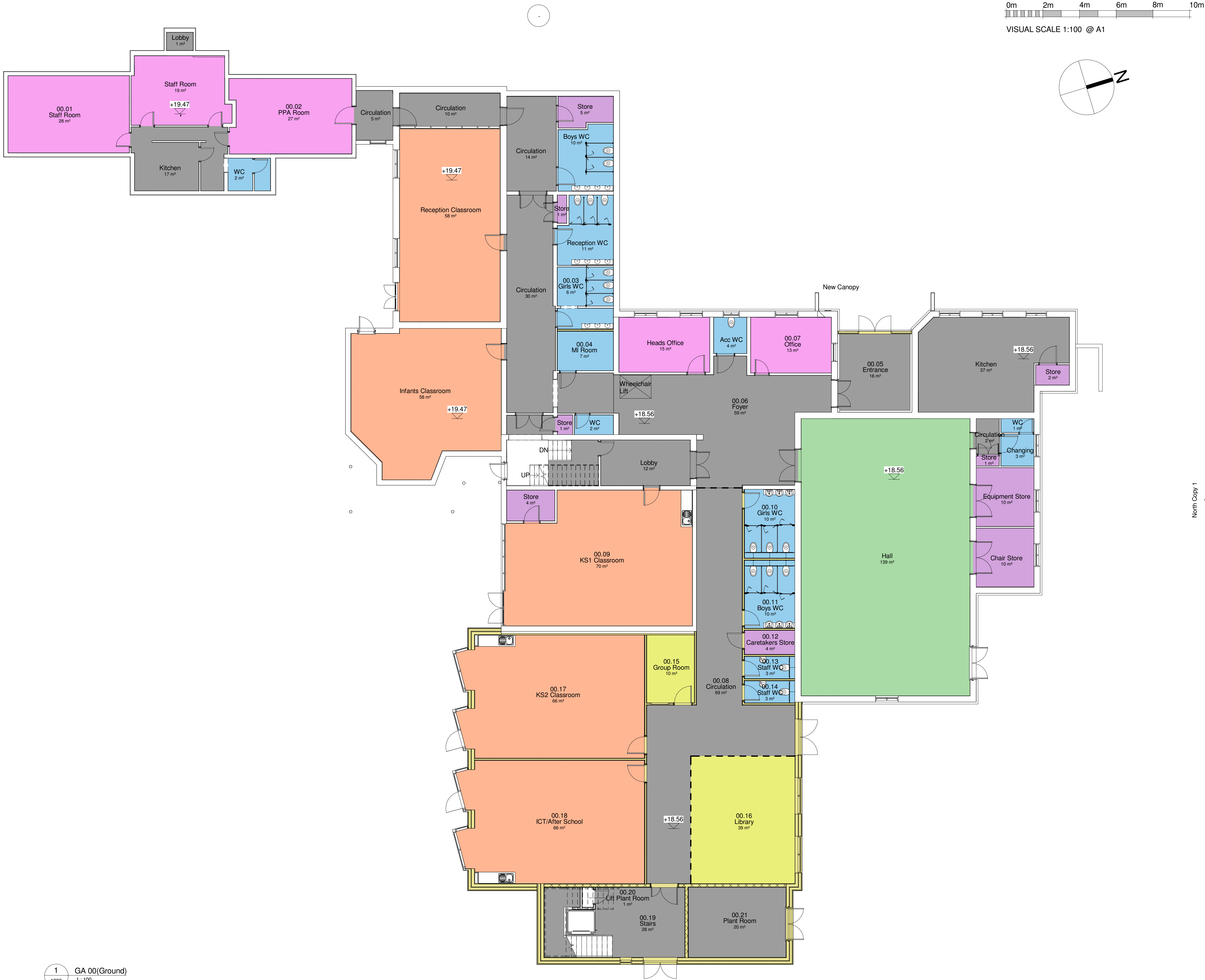

1 GA 00(Ground)
1:100

0m 2m 4m 6m 8m 10m
VISUAL SCALE 1:100 @ A1

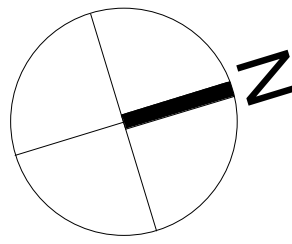

NO DIMENSIONS TO BE SCALED FROM THIS DRAWING	
CDM - RESIDUAL HAZARDS The following are considered to be significant risks relevant to this drawing, which could not be fully mitigated or removed through design:	
	CDM - RESIDUAL HAZARDS
1	NONE IDENTIFIED.

By Department Legend

- Large Spaces
- Learning Resource Areas
- Non-Net Areas
- Staff & Admin
- Storage
- Teaching Areas
- Toilets & Personal Care

New Wall

9060
North Copy 1

P06	Issued for Planning Application	05.02.18	DPT	RTO
P05	For Consultation	08.11.17	DPT	RTO
P04	Fourth Issue - For MS3 Report	13.10.17	WJS	DPT
P03	Third Issue-For MS3 Technical Review	03.10.17	WJS	DPT
P02	Public Planning Consultation	21.09.17	WJS	DPT
P01	Client Meeting	29.08.17	WJS	DPT

Revision	Date	Dm	Chk
This document references the following files:-			
Reference Name	Status	Revision	
15163-XX-ZZ-M3-A-0001	S1	P04	

Client			
Coulson Building Group for Cambridgeshire County Council			
Project			
Extension to Barrington C of E Primary School			
Drawing Title			
Plan-GA-L0(Ground)			
General Arrangement Plan			
Ground Floor			
Suitability Status			
S2 - Suitable for Information			
Job No.	Scale	Size	Rev
161667	1 : 100	@ A1	P06
Drawing Number			
15163 - PEV - XX - 00 - DR - A - 1200			
Project Code	Originator	Zone	Level
			Type
			Role
			Number

PICK
EVERARD